

| LOC |   | DIST |         | REVISIONS                 |      |    |       |
|-----|---|------|---------|---------------------------|------|----|-------|
| CM  | O | REV  | DATE    | DESCRIPTION               | DATE | BY | APP'D |
| T   |   |      | 25FEB07 | REVISED PER ECO-07-003755 |      | KW | DB    |

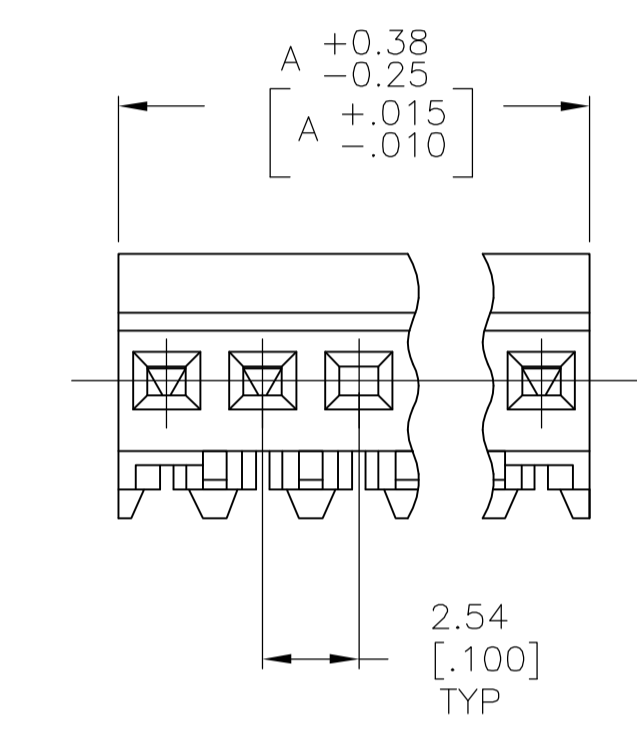

- 1 MATERIAL: CONNECTOR - NYLON UL94V-2 (WHITE).  
 CONTACTS - 0.30[.012] THICK COPPER ALLOY  
 MATTE WHISKER MITIGATED TIN  
 0.00203[.000080] MIN THICKNESS  
 OVER NICKEL UNDERPLATE OR BRIGHT  
 TIN-LEAD 93/7 0.00203[.000080] MIN  
 THICKNESS. SEE FINISH COLUMN FOR  
 PLATING TYPE.
- 2. CONTACTS ACCEPT 24 AWG WIRE WITH 1.52[.060] MAX  
 INSULATION DIAMETER.
- 3. CONTACTS MUST ACCEPT 0.64±0.03 [.025±.001] SQUARE  
 POST AND REMAIN LOCKED IN POSITION.
- 4 IDENTIFICATION NUMBER FOR LAST CIRCUIT MAY  
 NOT APPEAR ON ALL ASSEMBLIES.
- 5. DIMENSIONS IN BRACKETS ARE IN INCHES.
- 6. HOUSING FEATURES ARE: CLOSED END WITH LOCKING  
 RAMP.
- 7 DETAIL A SHOWS CIRCUIT NO.3 MOLDED CLOSED.

| FINISH   | DIM A        | NO OF CIRCUITS | PART NO    |
|----------|--------------|----------------|------------|
| TIN      | 12.70 [.500] | 5              | 3-641818-5 |
|          | 10.16 [.400] | 4              | 3-641818-4 |
| TIN-LEAD | 12.70 [.500] | 5              | 641818-5   |
|          | 10.16 [.400] | 4              | 641818-4   |

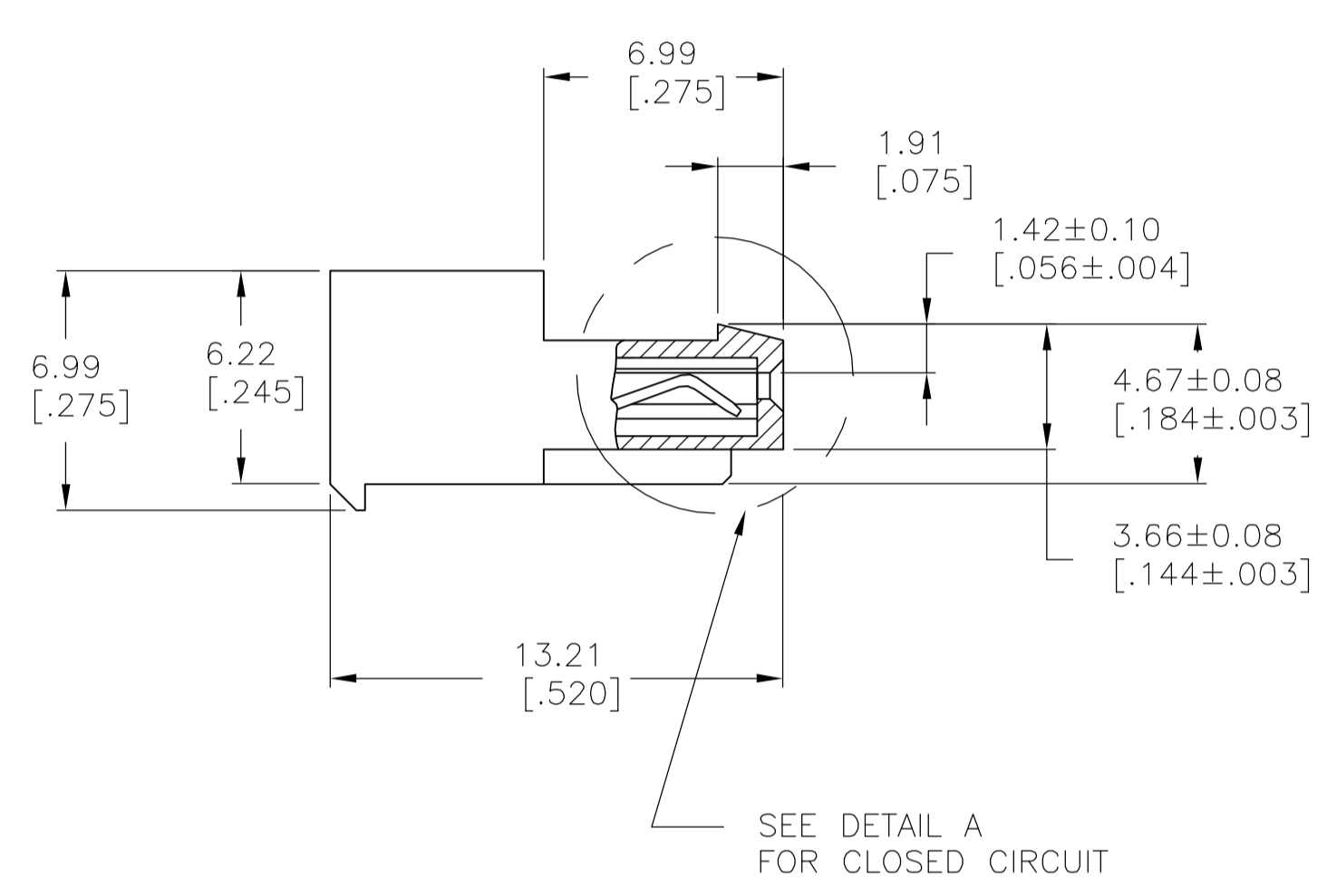
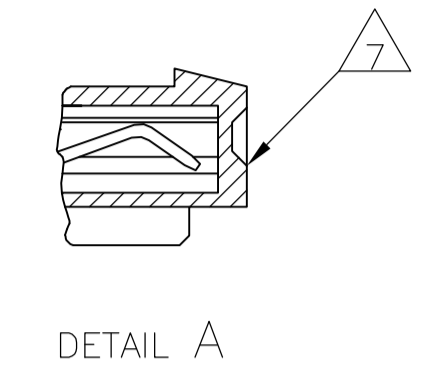
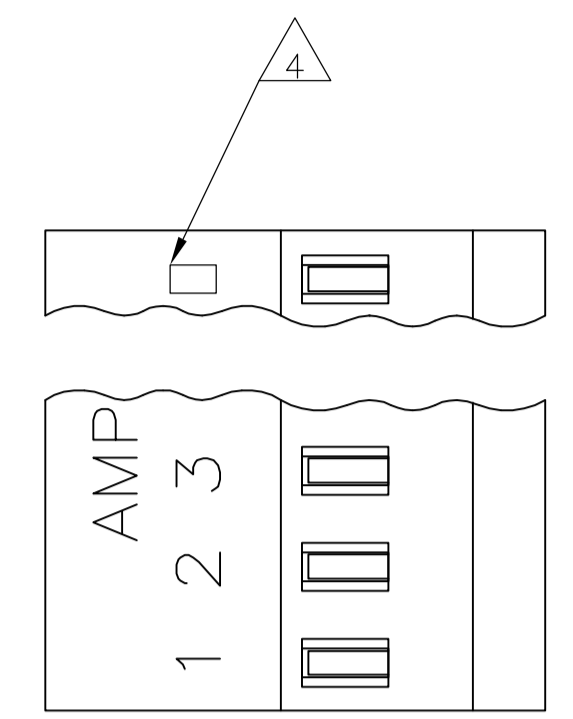

THIS DRAWING IS A CONTROLLED DOCUMENT.

|                            |  |                              |                                  |                        |                    |                          |   |
|----------------------------|--|------------------------------|----------------------------------|------------------------|--------------------|--------------------------|---|
| DIMENSIONS:<br>mm [INCHES] | TOLERANCES UNLESS OTHERWISE SPECIFIED: | DWG<br>B. LEWIS<br>22 APR 91 | APPROV<br>G. MILLER<br>22 APR 91 | NAME<br>G. MILLER      | DATE<br>22 APR 91  | tyco<br>Electronics      | Tyco Electronics Corporation<br>Harrisburg, Pa 17105-3608 |
| 0 PLC ± -                  | 1 PLC ± -                              | 2 PLC ± -                    | 3 PLC ± .13 [.005]               | 4 PLC ± -              | ANGLES ± -         | PRODUCT SPEC<br>108-1050 | APPLICATION SPEC<br>114-1019                              |
| MATERIAL<br>1              | FINISH<br>1                            | WEIGHT<br>-                  | SCALE<br>A1 00779                | DRAWING NO<br>C=641818 | RESTRICTED TO<br>- | CUSTOMER DRAWING         | SCALE 5:1 SHEET 1 OF 1 REV T                              |